



**£210,000**

11 Severn Court Burton Latimer NN15 5SS



**Carter Williams**  
Estate and Letting Agents



Situated within a cul-de-sac on the popular Severn Court in Burton Latimer, this three-bedroom semi-detached home is offered to the market with the added advantage of no onward chain, making it an excellent opportunity for first-time buyers, investors, or those seeking a straightforward move.

Occupying a generous corner plot, the property enjoys a sizeable wrap-around garden extending to the side and rear, providing excellent outdoor space with plenty of potential for families, gardening enthusiasts, or those looking to further enhance the property. The home is approached via a low-maintenance front garden with a paved pathway leading to a gated side entrance and the main front door. Upon entering, an entrance hallway provides access to the principal ground floor accommodation, with stairs rising to the first floor. To the front of the property is a bright and spacious living room, benefiting from a large front-facing window that fills the room with natural light. To the rear, the kitchen/dining room offers a practical and sociable space, featuring a range of base and wall-mounted units, ample work surface space, plumbing for white goods, built-in understairs storage, a rear-facing window, and space for a dining table. A conservatory is accessed directly from the kitchen and provides an additional reception area, with a door opening onto the rear garden. The first floor comprises three bedrooms, two of which are comfortable doubles, together with a three-piece family bathroom fitted with a shower over the bath. There is also useful built-in over-stairs storage located off the landing. Externally, the wrap-around garden is a particular feature of the property. A patio area sits immediately outside the conservatory, creating an ideal space for outdoor seating and entertaining, while the remainder is predominantly laid to lawn. The generous plot also offers ample room for garden storage and further landscaping if desired.

While the property would benefit from some cosmetic updating in places, it offers well-proportioned, move-in-ready accommodation with excellent scope for buyers to personalise and add value over time. Early viewing is highly recommended to appreciate the position, plot size, and potential this property has to offer.

Council Tax Band: B  
EPC Rating: C





Lounge 4.68m (15' 4") x 3.61m (11' 10")

Kitchen/ Diner 3.75m (12' 4") Max x  
4.67m (15' 4")

Conservatory 2.28m (7' 6") x 2.07m (6' 9")

Bedroom 4.71m (15' 5") x 2.79m (9' 2")

Bedroom 2.61m (8' 7") x 2.72m (8' 11")

Bedroom 2.73m (8' 11") x 2.01m (6' 7")

Bathroom 1.82m (6' 0") x 1.65m (5' 5")

Garden





GROUND FLOOR  
414 sq.ft. (38.5 sq.m.) approx.

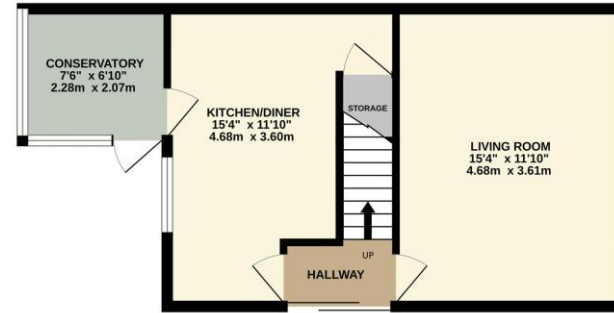

1ST FLOOR  
363 sq.ft. (33.7 sq.m.) approx.

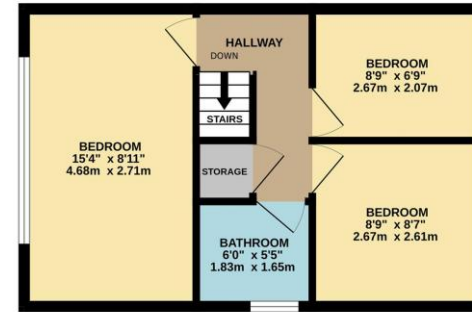

TOTAL FLOOR AREA: 777 sq.ft. (72.2 sq.m.) approx.

Whilst every attempt has been made to ensure the accuracy of the floorplan contained here, measurements of doors, windows, rooms and any other items are approximate and no responsibility is taken for any error, omission or mis-statement. This plan is for illustrative purposes only and should be used as such by any prospective purchaser. The services, systems and appliances shown have not been tested and no guarantee as to their operability or efficiency can be given.  
Made with Metropix ©2025

Energy Efficiency Rating		Current	Potential
Very energy efficient - lower running costs			
(92-100)	A		89
(81-91)	B		
(69-80)	C		
(55-68)	D	70	
(39-54)	E		
(21-38)	F		
(1-20)	G		
Not energy efficient - higher running costs			
England & Wales		EU Directive 2002/91/EC	

Environmental Impact (CO <sub>2</sub> ) Rating		Current	Potential
Very environmentally friendly - lower CO <sub>2</sub> emissions			
(92-100)	A		
(81-91)	B		
(69-80)	C		
(55-68)	D		
(39-54)	E		
(21-38)	F		
(1-20)	G		
Not environmentally friendly - higher CO <sub>2</sub> emissions			
England & Wales		EU Directive 2002/91/EC	

# Selling your property?

Get in touch to arrange your  
FREE market appraisal!

- Honest, friendly advice from a hardworking dedicated team
- Regular market updates
- Professional photography
- Floorplans
- Advertising on major property portals
- Exposure on social media
- Excellent local knowledge
- Mortgage advice
- In-house energy performance assessor
- Fantastic customer service

Find out why so many people trust  
Carter Williams with their property needs!



60 High Street  
Burton Latimer  
NN15 5LB  
01536 723561  
[info@carter-williams.co.uk](mailto:info@carter-williams.co.uk)  
[www.carter-williams.co.uk](http://www.carter-williams.co.uk)

